

**Facade Panel and
Thin Brick
Production**
by Don Denison



Facade Panels



- New trends in architectural design





- New trends in architectural design
- Clay facade panels are one of the ceramic industry's answers





- New trends in architectural design
- Clay facade panels are one of the ceramic industry's answers
- High-margin product





- **New trends in architectural design**
- **Clay façade panels are the ceramic industries' answer**
- **High-margin product**
- **Many brickmakers ask to make this product**



- **New trends in architectural design**
- **Clay façade panels are the ceramic industry's answer**
- **High-margin product**
- **Many brickmakers ask to make this product**
- **Several different production methods**

Production Topics:

Façade Panels:

Split tile

Flat extrusion

Thin Brick:

Split tile

Flat extrusion



Ceramicas Mora, Spain

Two production lines for bricks and facade panels



- Toledo
Spain 2007
- Panels up to 32".
- Two lines with two extruders and two cutters
- Continuous pallet dryer and tunnel kiln

Ceramicas Mora, Spain 2007

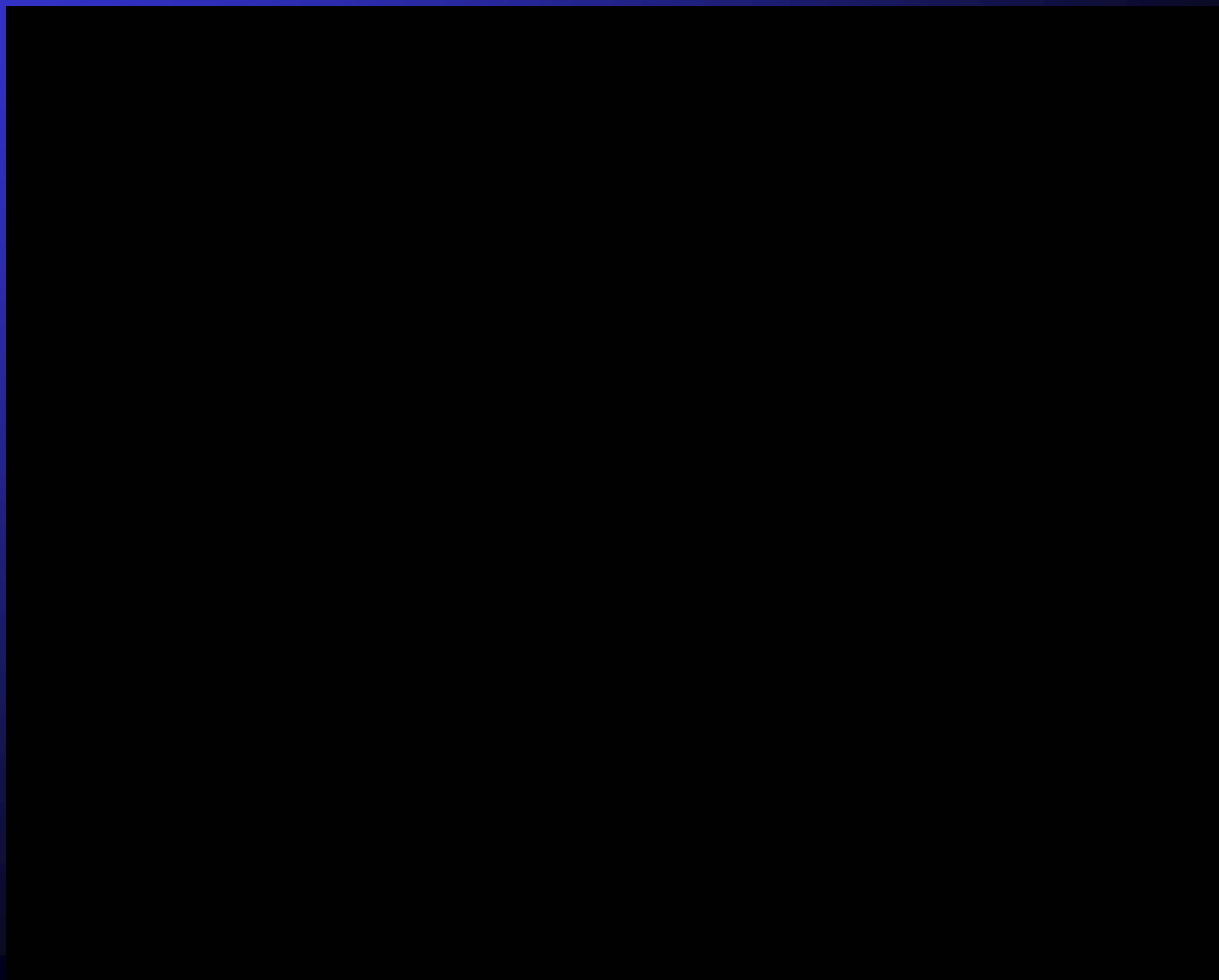

CN Ceramic, China 2007

Plant for panels up to 4 feet length



- **Content: greenside, dryer, loading and unloading equipment**
- **Capacity of 8 million square feet/yr**
- **First robot system incorporated in this industry**
- **Chinese roller hearth kiln**

CN Ceramic, China 2007
Plant for panels up to 4 feet length



LINGL

CN Ceramic, China 2007
Plant for panels up to 4 feet length



LINGL

CN Ceramic, China 2007
Application Method



CN Ceramic, China 2007
Plant for panels up to 4 feet length



LINGL

CN Ceramic, China 2007
Plant for panels up to 4 feet length

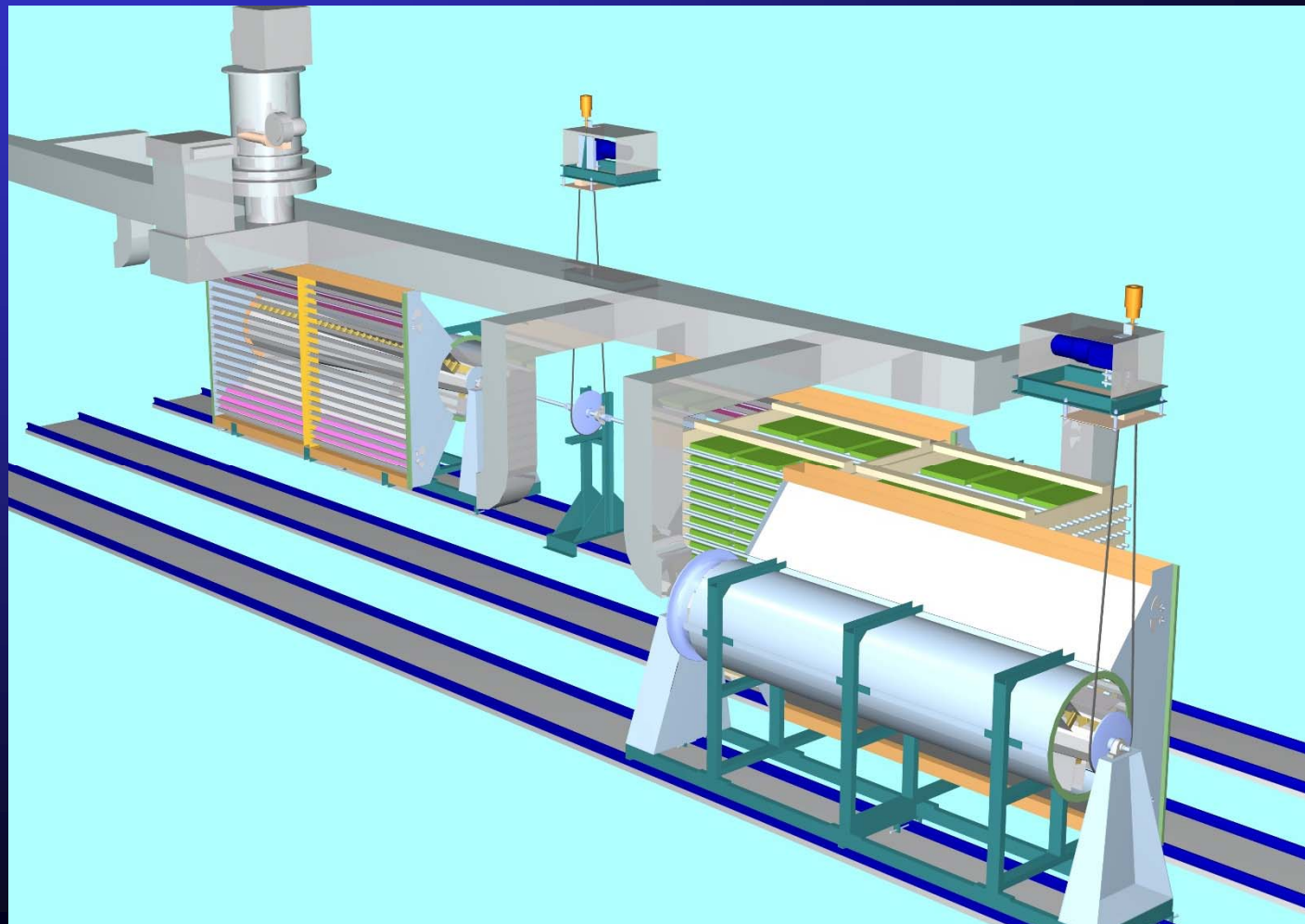

LINGL

CN Ceramic, China 2007
Plant for panels up to 4 feet length



CN Ceramic, China 2007



LINGL

CN Ceramic, China 2007

Plant for panels up to 4 feet length



LINGL

Plant for Facade Panels

Modular plant for panels up to 80"

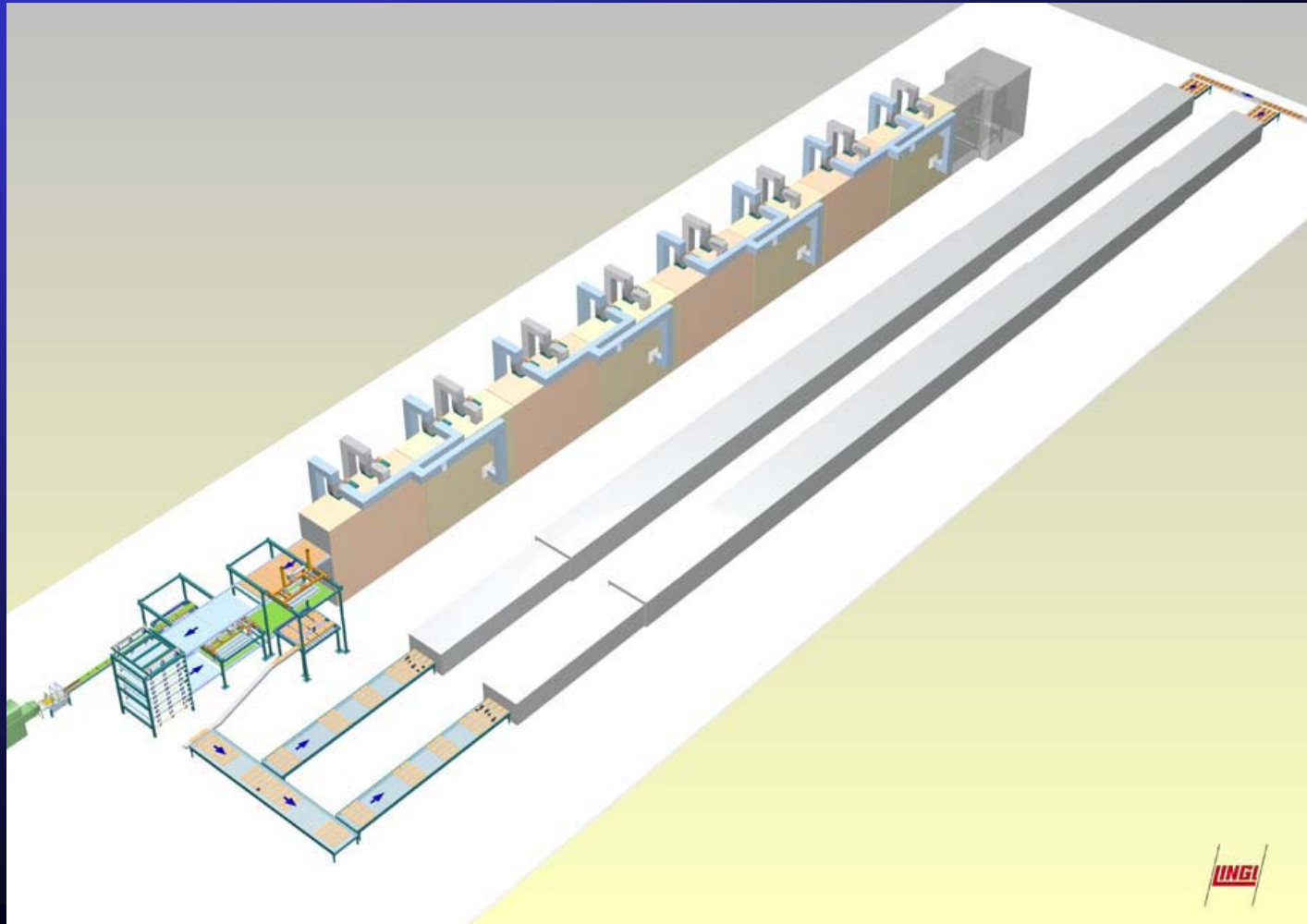

Plant for Facade Panels

Modular dryer for panels up to 80"

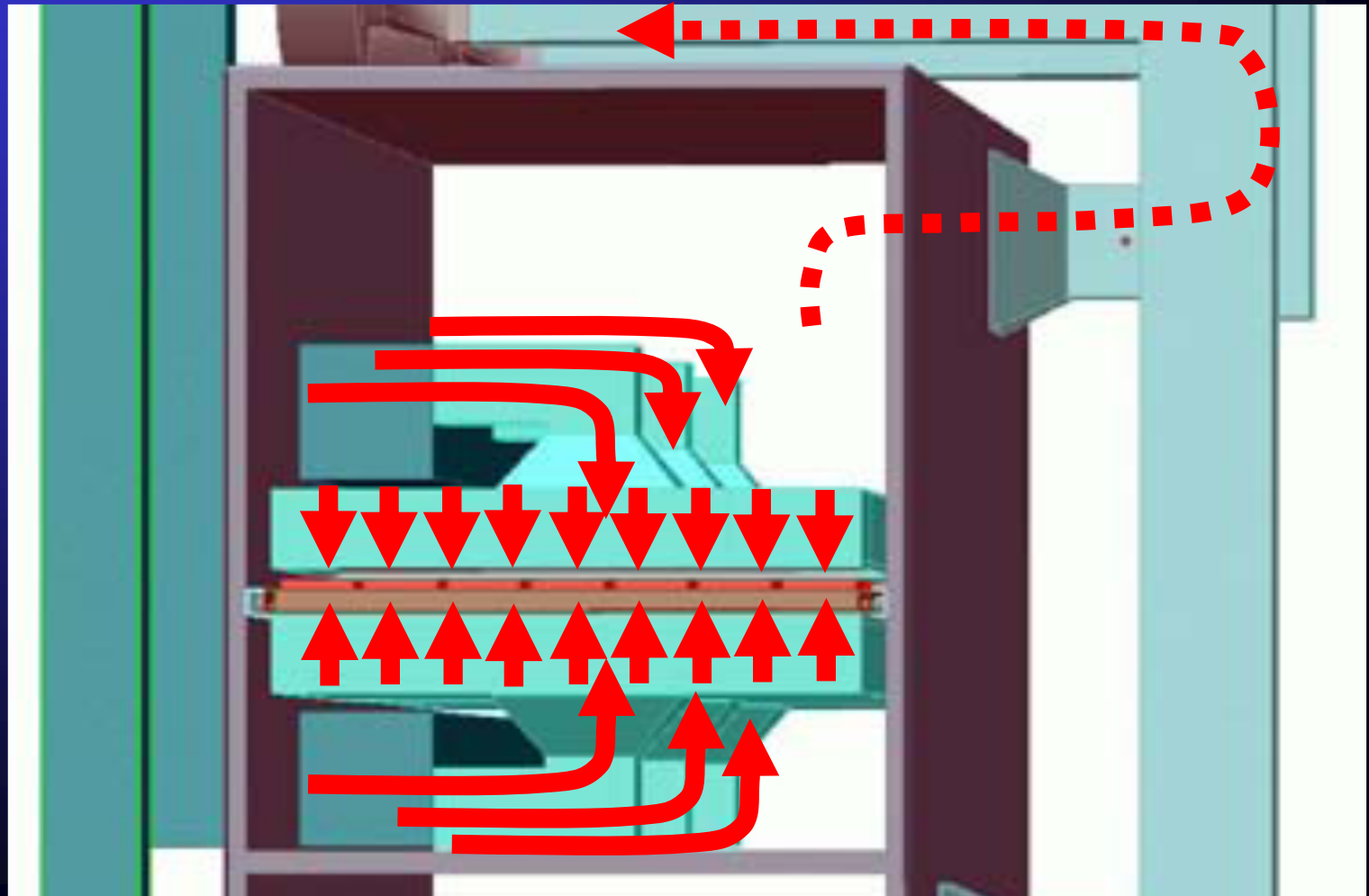

Plant for Facade Panels

Modular dryer for panels up to 80"

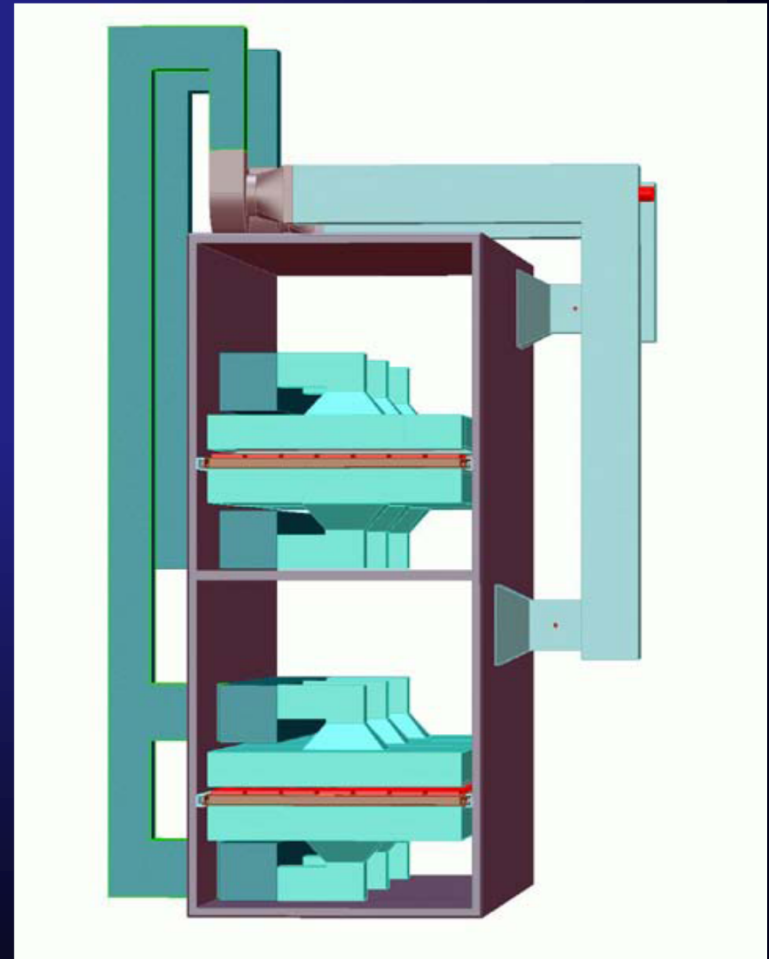
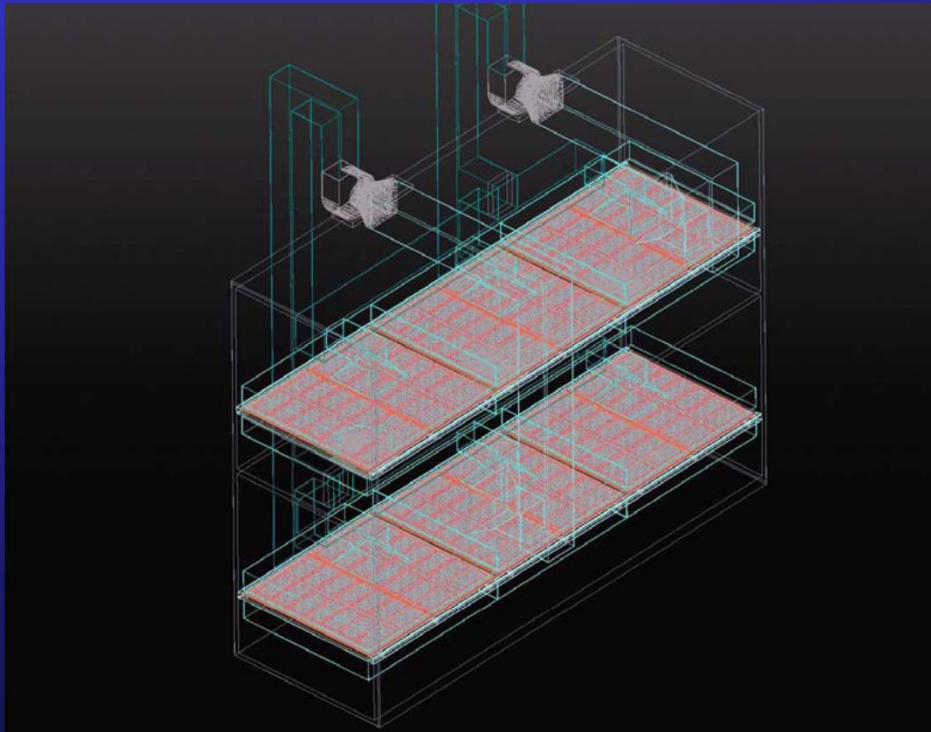

Plant for Facade Panels

Modular dryer for panels up to 80"

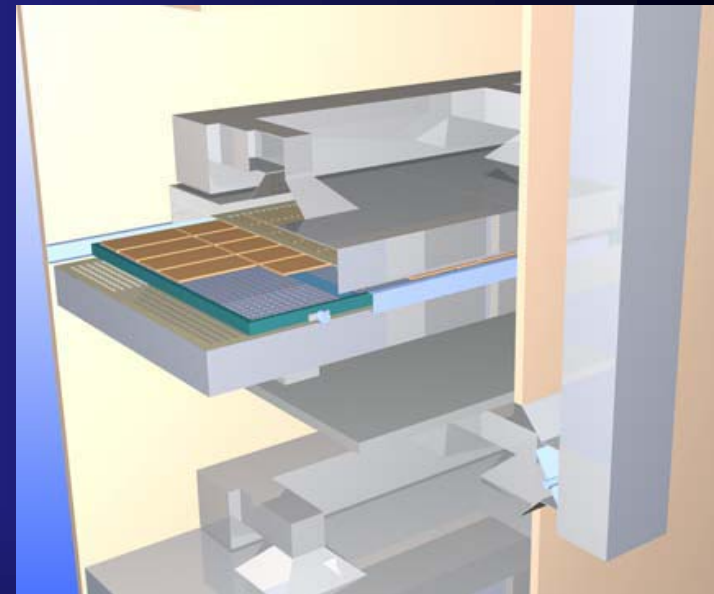
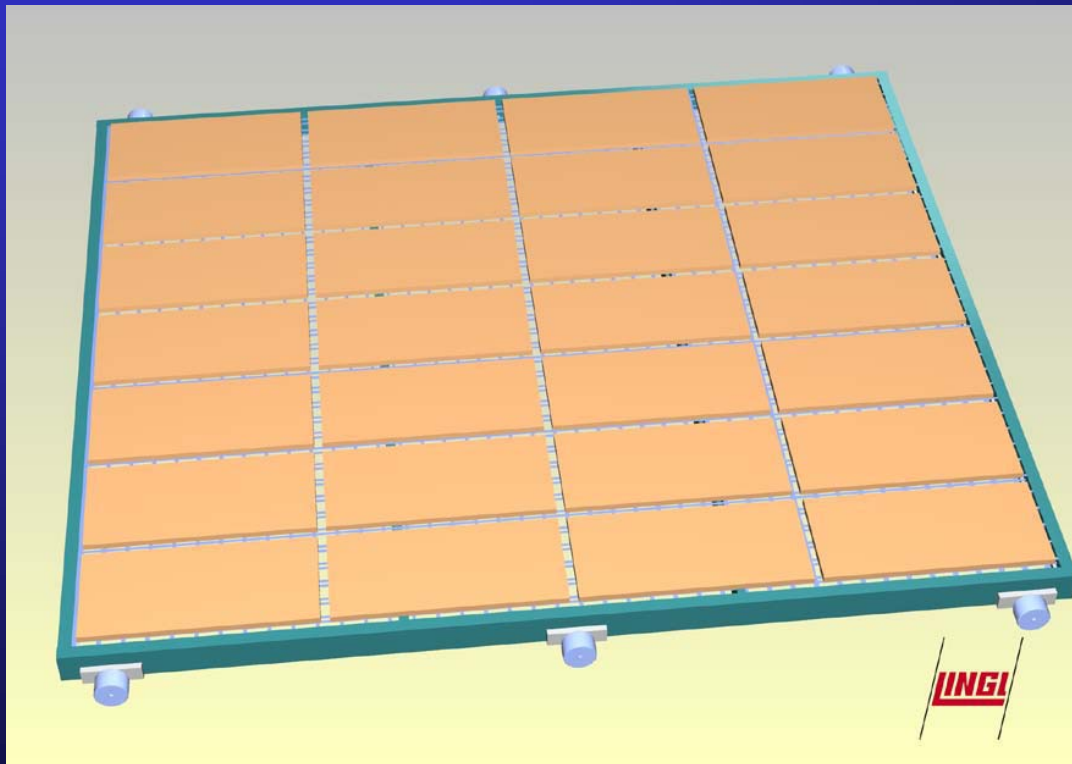

Plant for Facade Panels

Modular dryer for panels up to 80"

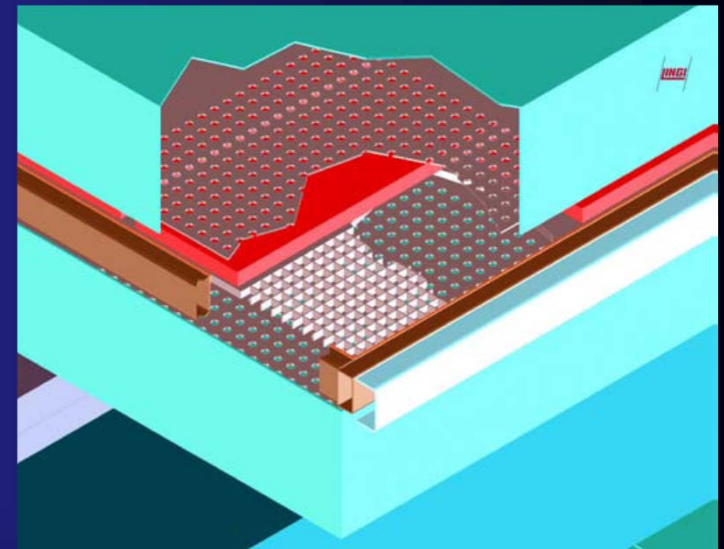
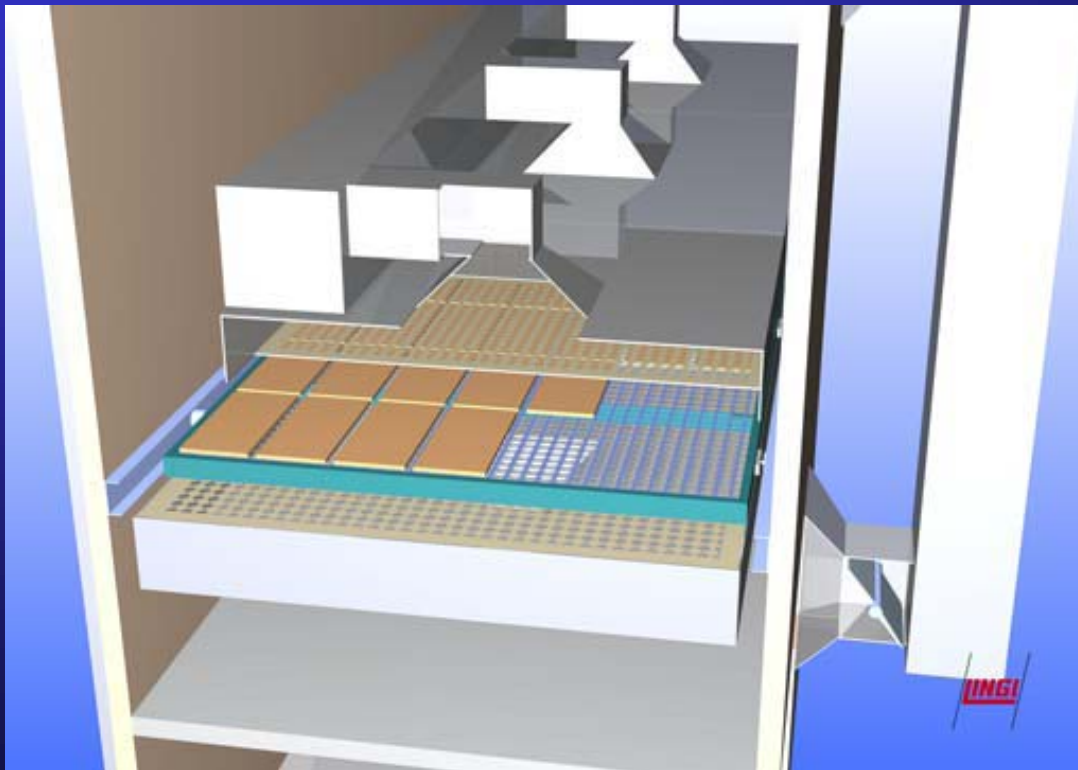

Plant for Facade Panels

Modular dryer for panels up to 80"

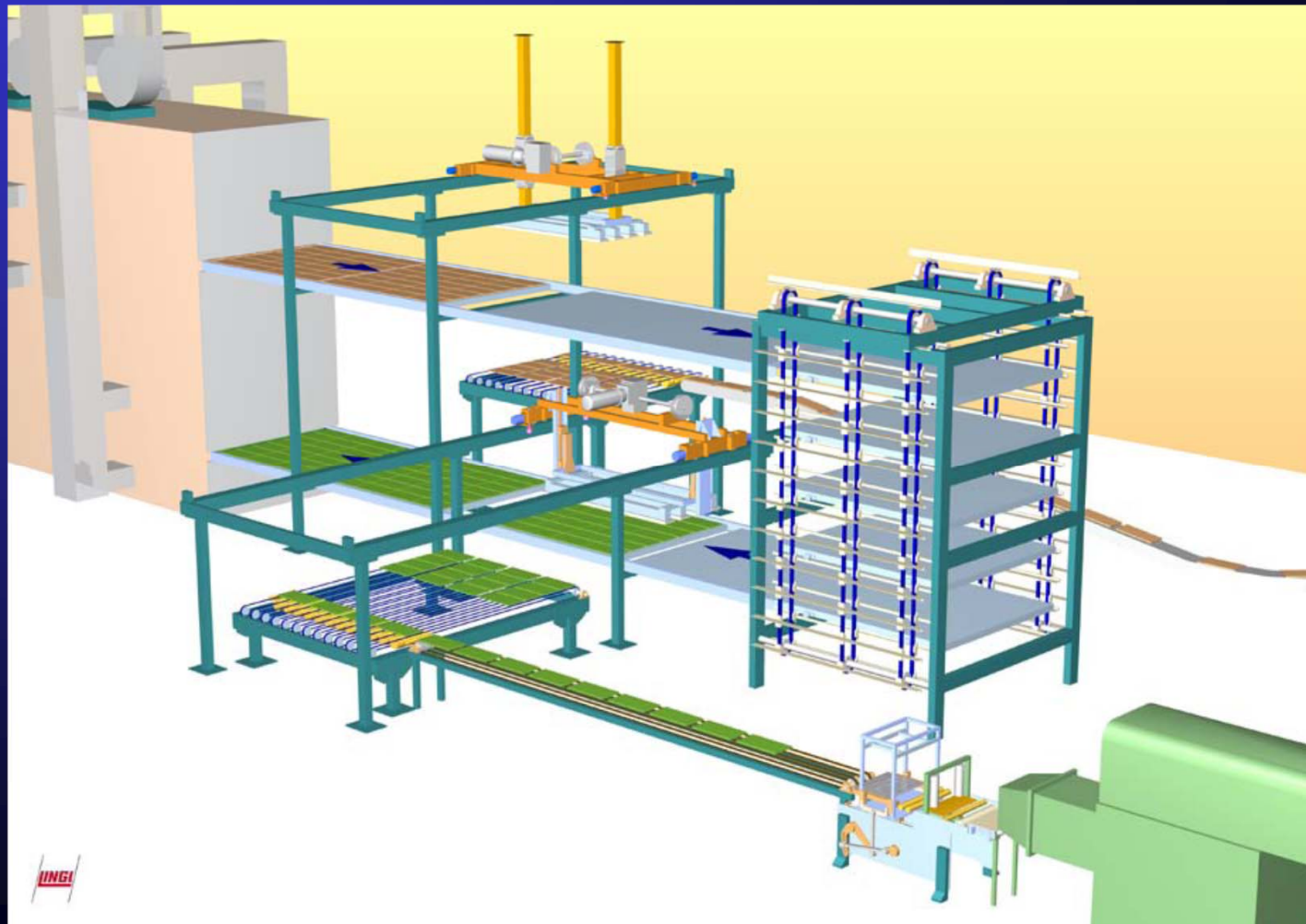

LINGL

LINGL

Plant for Facade Panels
Modular dryer for panels up to 80"



LINGL



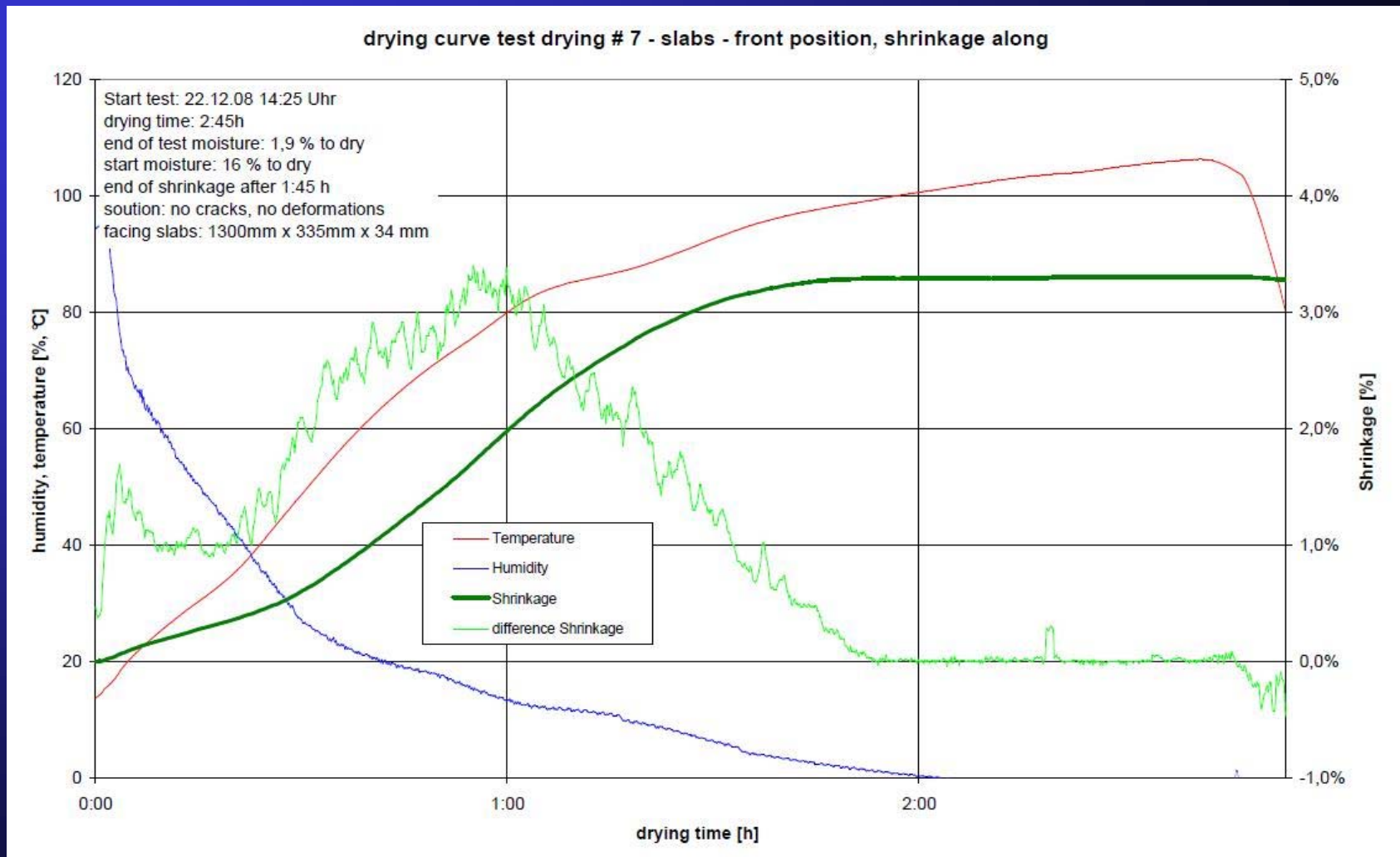

Plant for Facade Panels

Modular kiln for panels up to 80"

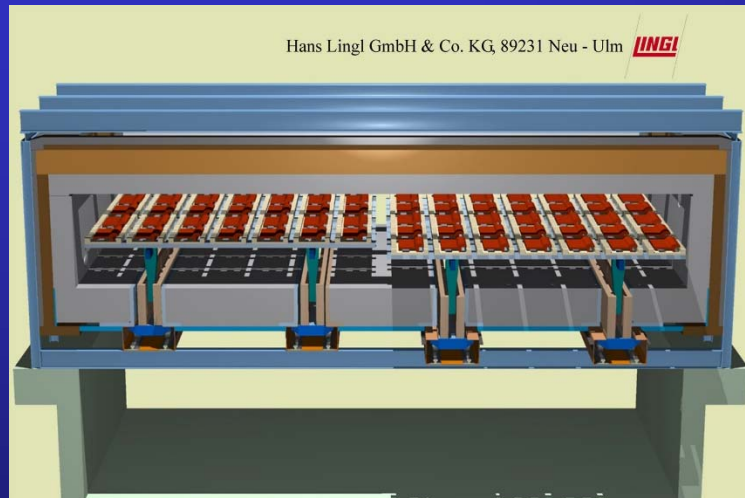

Thin Brick



Production Topics:

Façade Panels:

Split tile

Flat extrusion

Thin Brick:

Split tile

Flat extrusion



Endicott:

- 2 Plants
 - Pallet Drying Plant
 - Direct-set Plant
- 2 Extrusion Lines
- Presently manufacture ~ 5 m sq.ft/yr.
 - Adding ~ 3 m sq.ft/yr.

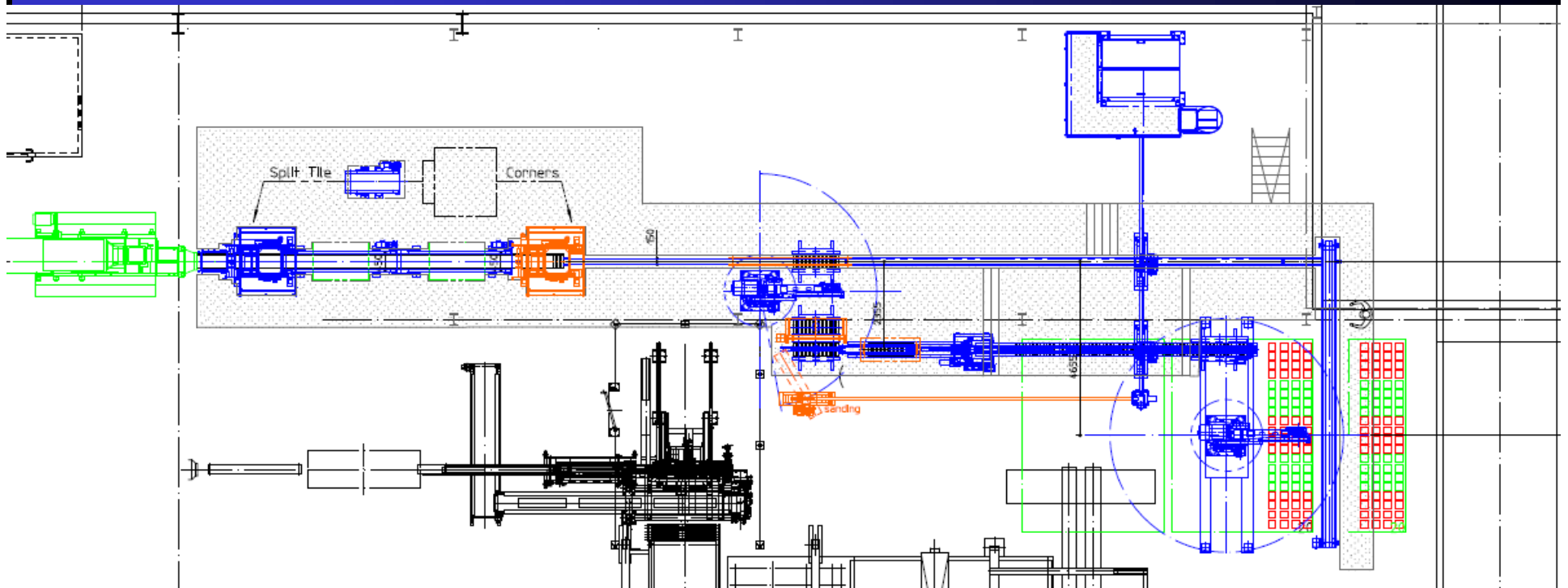

Endicott Clay Products



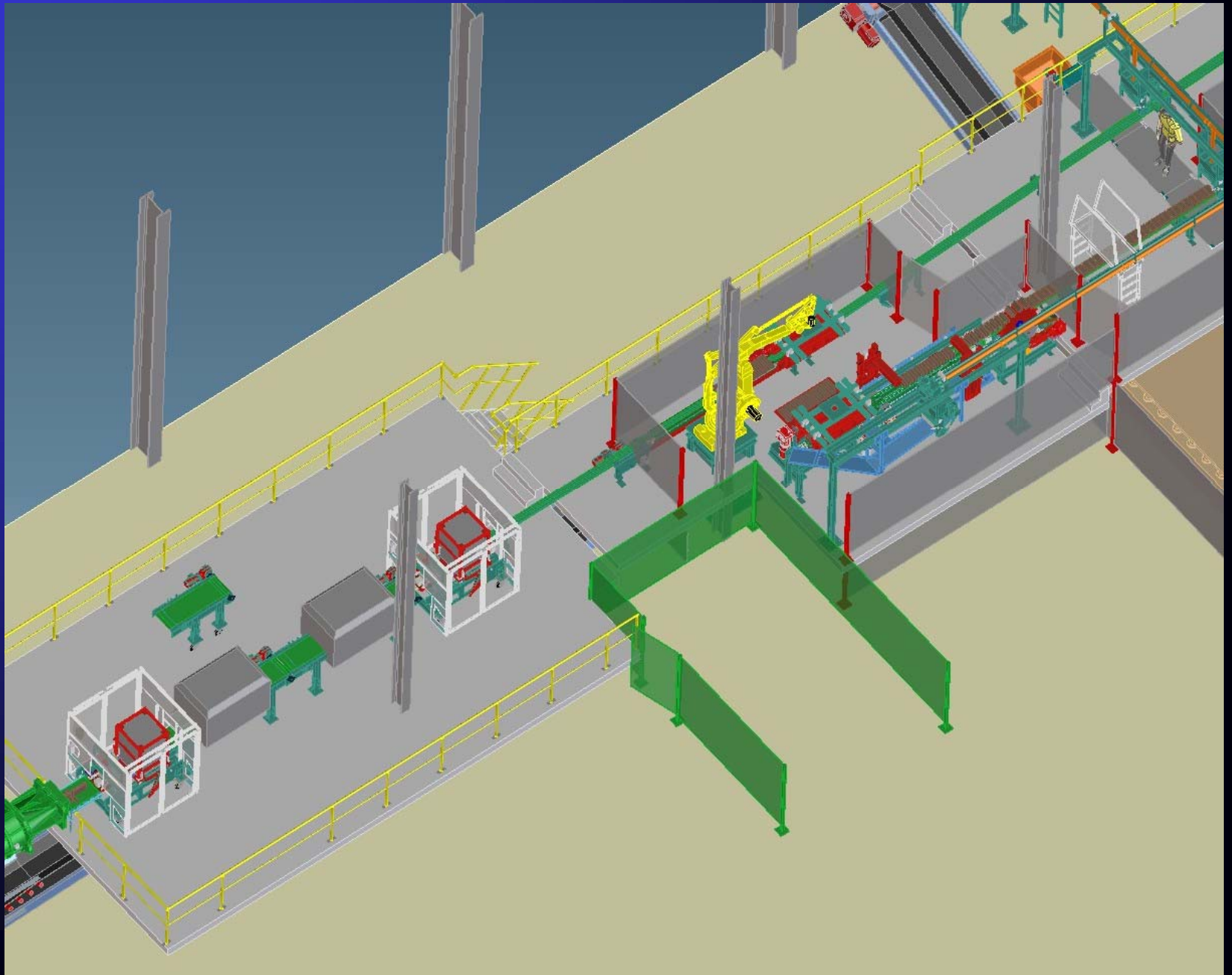

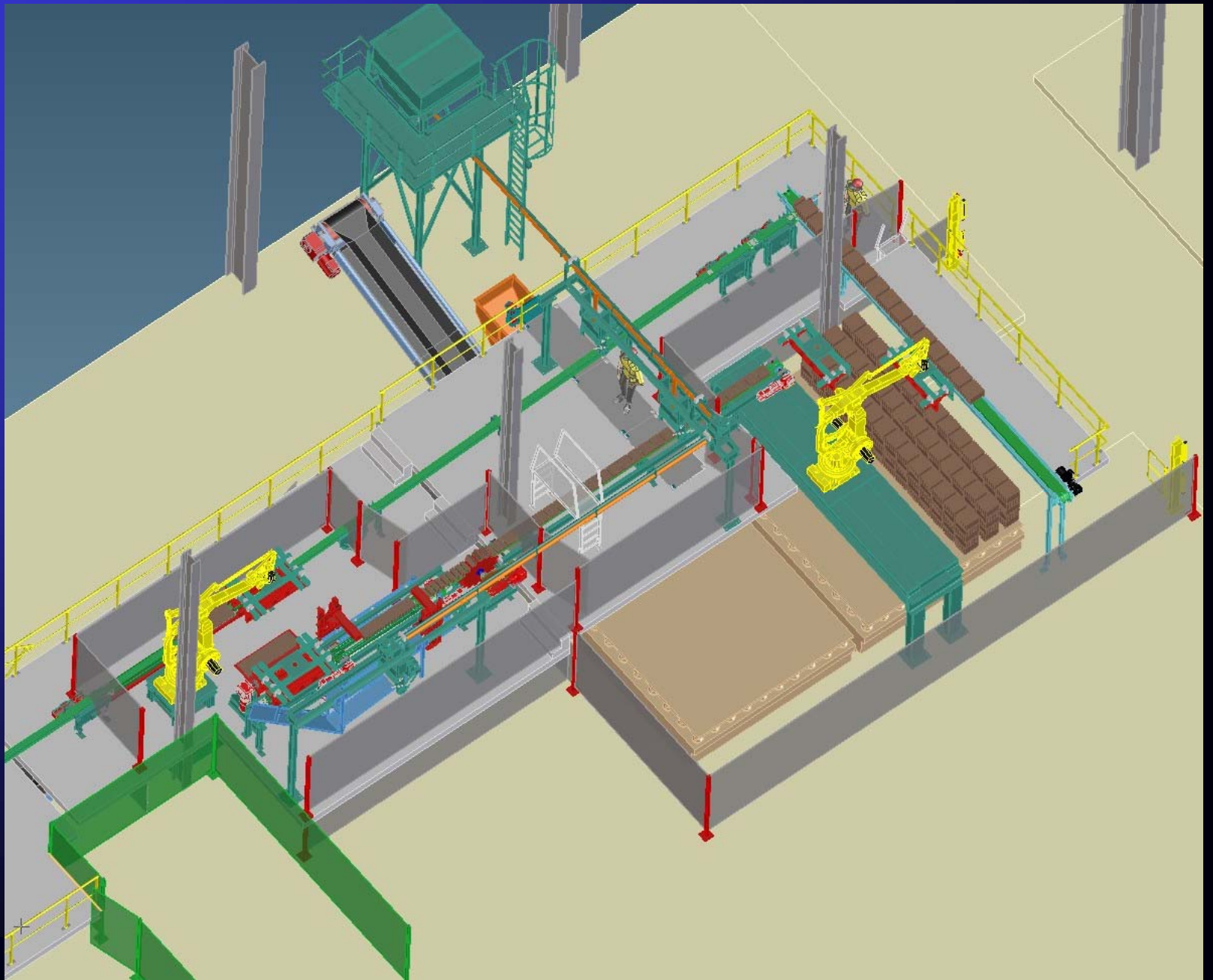

LINGI

Thin Brick
Flat Extruded





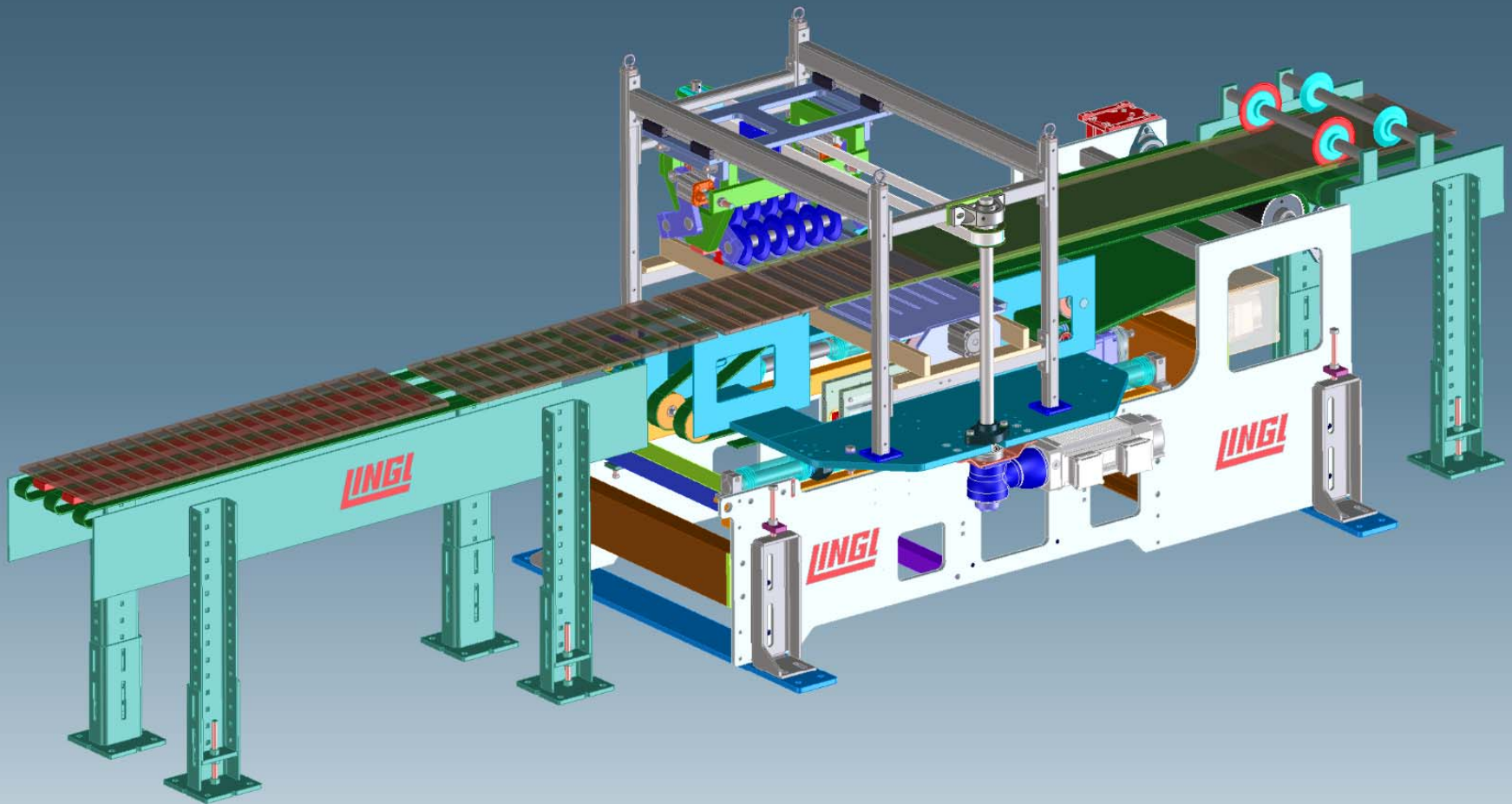

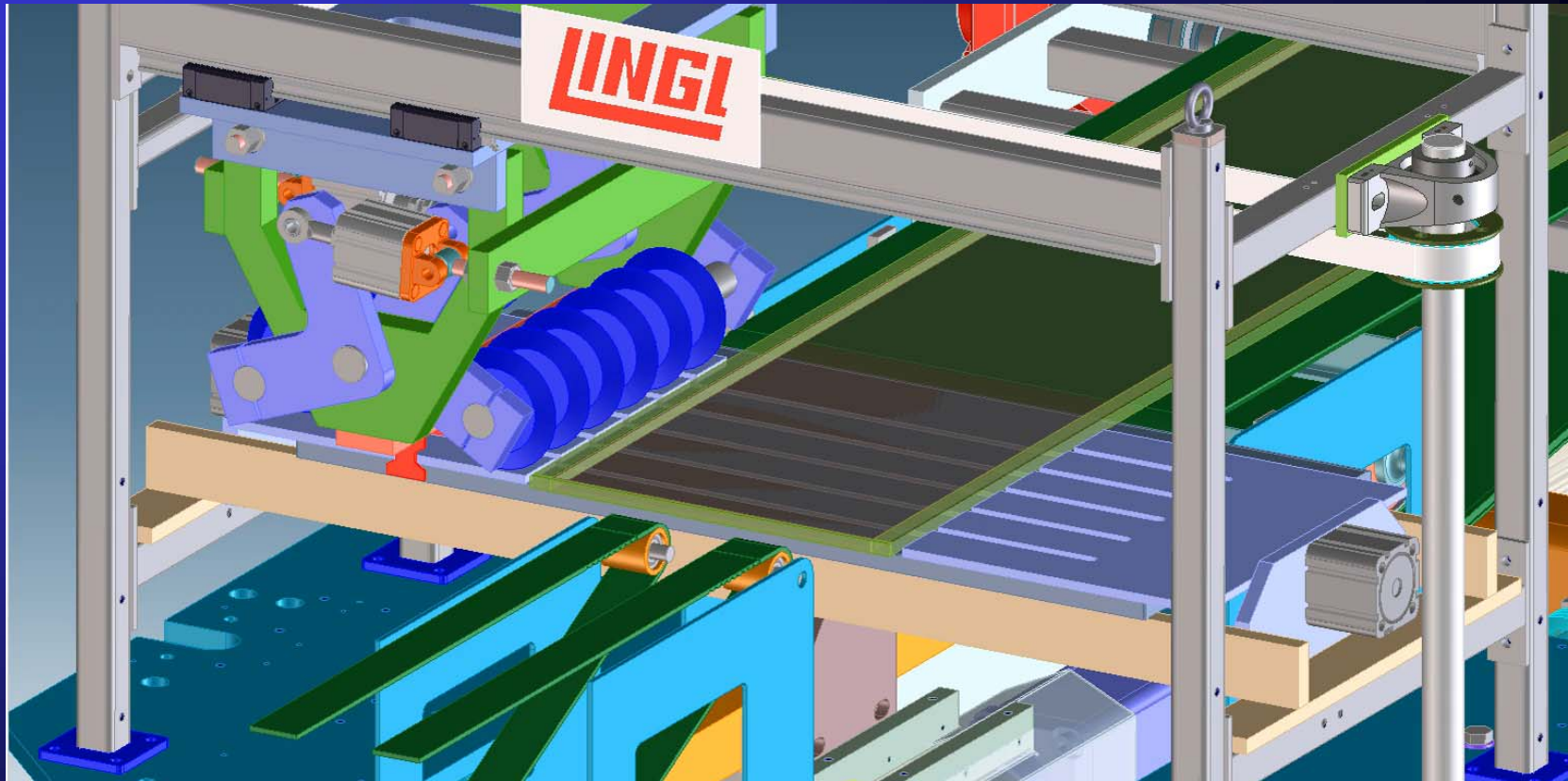

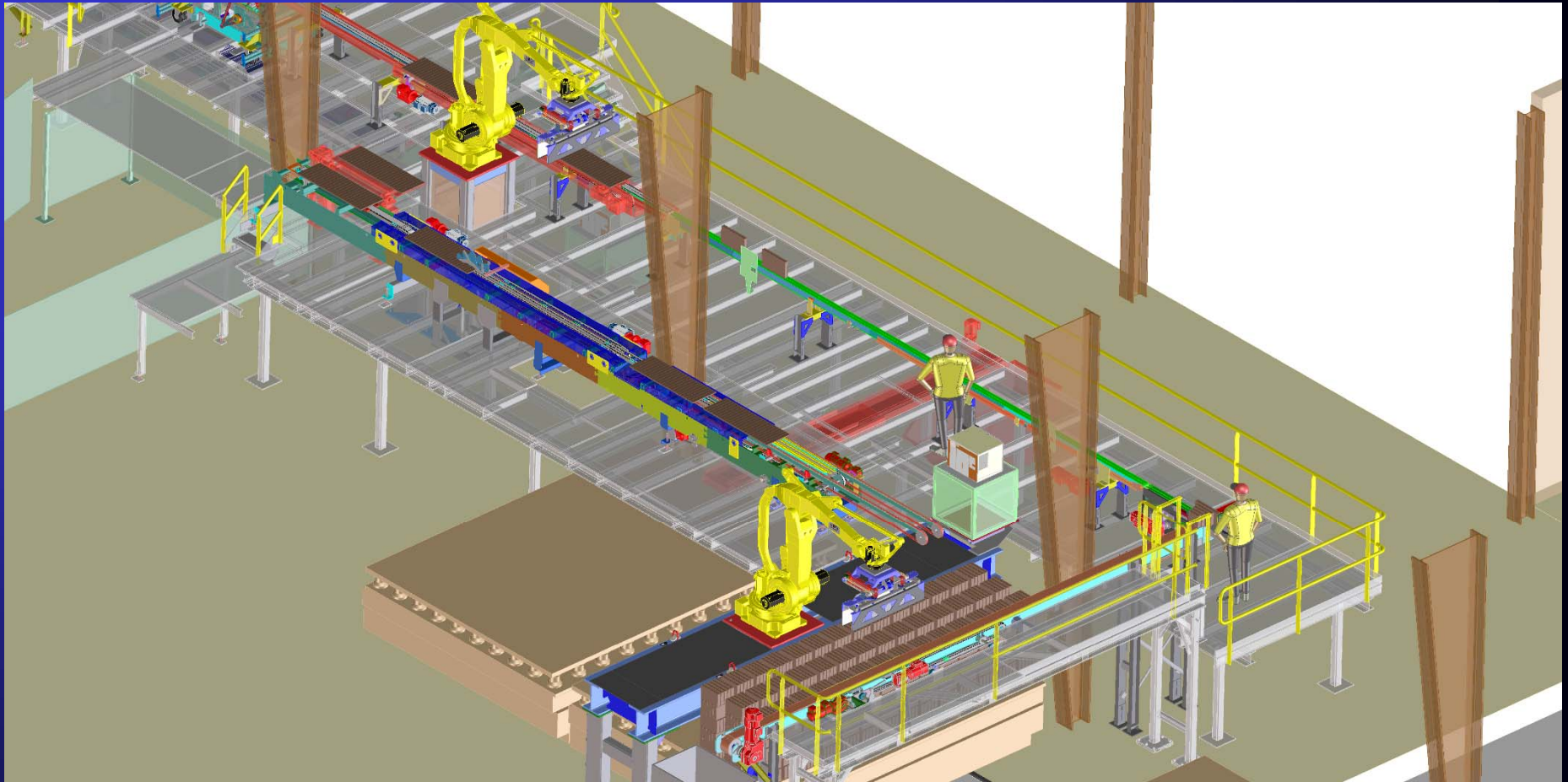

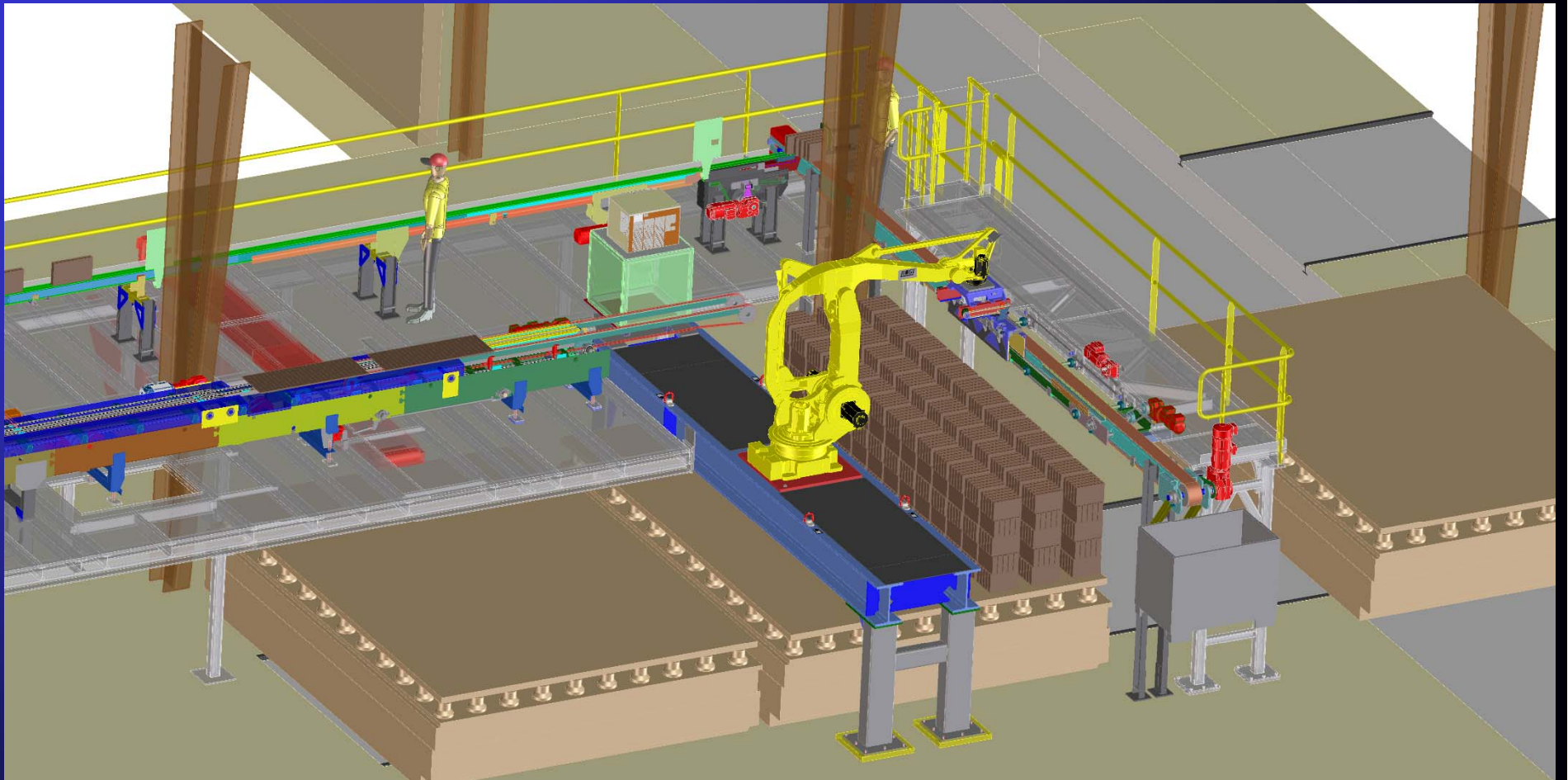

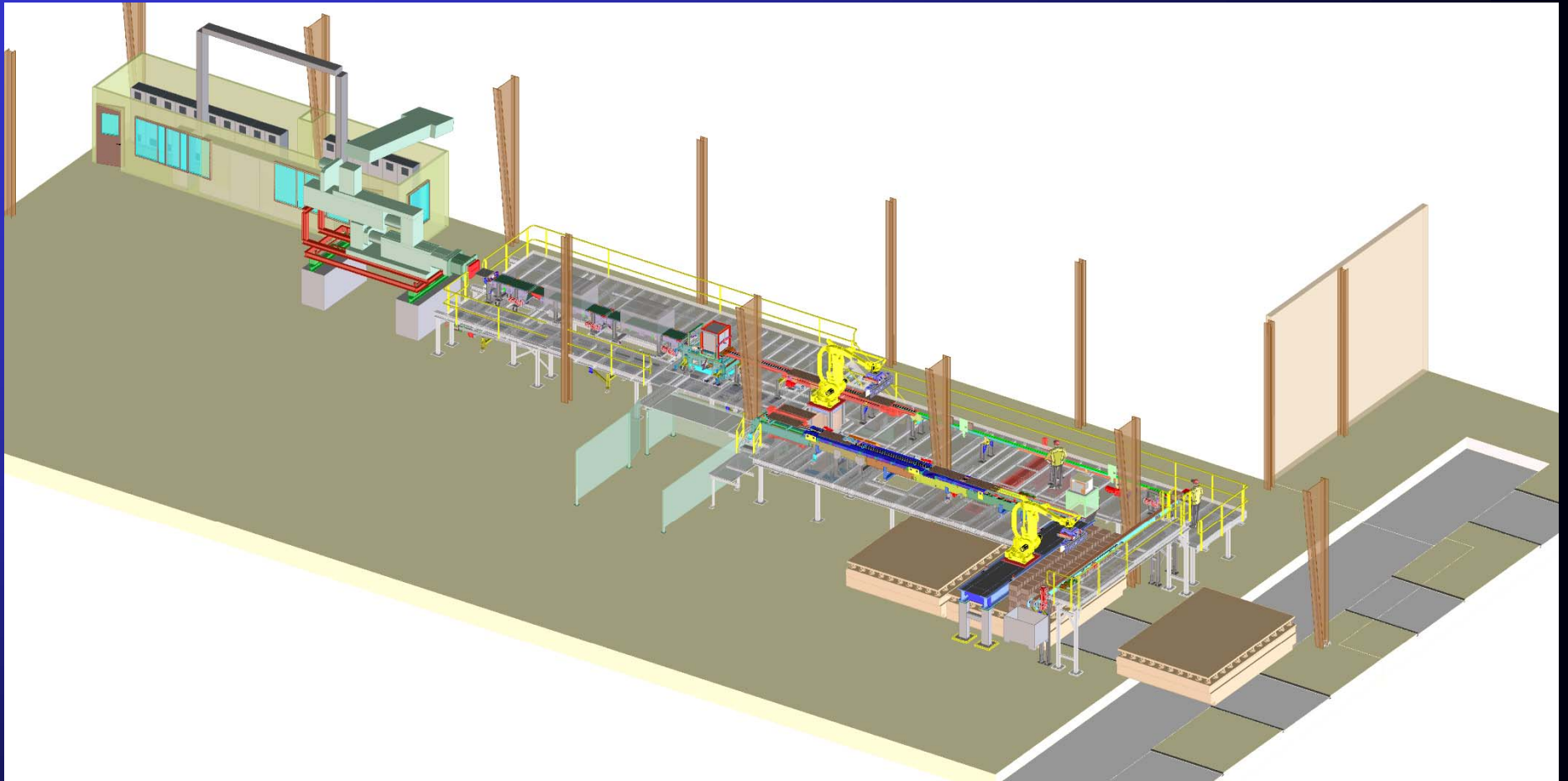



Existing Shapes Line.



Discussed:

Façade Panels:

Split tile

Flat extrusion

Thin Brick:

Split tile

Flat extrusion

